

DISCLAIMER:
 THIS FLOOR PLAN IS FOR REFERENCE ONLY.
 LOCAL BUILDING CODES AND REGULATIONS
 MAY CONFLICT.

EXTERIOR FLOOR PLAN WINDOW AMOUNT = 16
 EXTERIOR FLOOR PLAN DOOR AMOUNT = 2

3'-4" 3'-10" MAIN FLOOR PLAN

REVISIONS			
NO.	DATE	DESCRIPTION	BY CK'D

KODIAK STEEL HOMES
 Kodiak Steel Homes, Inc
 7301 Industry Drive
 North Little Rock, AR 72117

DESCRIPTION: DOWNSTAIRS FLOOR PLAN

STYLE: CRESTWOOD 3 SIZE: 40'-0" X 48'-0"

DRN. BY	CK'D BY	DATE	SCALE	CODE	SHEET NO.	REV. #
EAP	HDS	04/03	NTS	CUB	A2 OF 10	

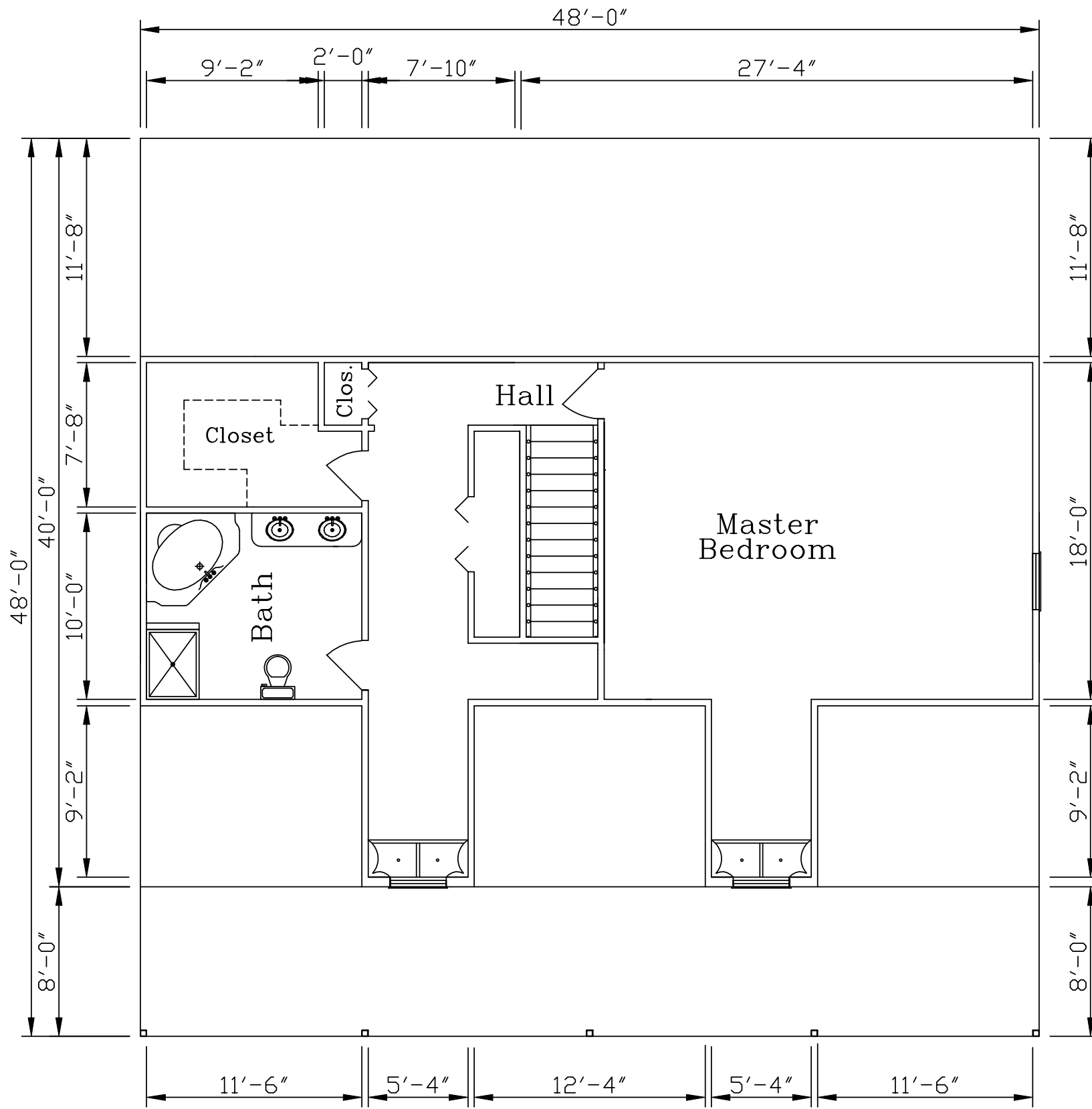

DISCLAIMER:
 THIS FLOOR PLAN IS FOR REFERENCE ONLY.
 LOCAL BUILDING CODES AND REGULATIONS
 MAY CONFLICT.

UPPER FLOOR PLAN

EXTERIOR FLOOR PLAN WINDOW AMOUNT = 3
 EXTERIOR FLOOR PLAN DOOR AMOUNT = 0

5/2/2005 11:04:24 AM

REVISIONS			
NO.	DATE	DESCRIPTION	BY CK'D

KODIAK STEEL HOMES		Kodiak Steel Homes, Inc 7301 Industry Drive North Little Rock, AR 72117	
DESCRIPTION: UPSTAIRS FLOOR PLAN		STYLE: CRESTWOOD 3	
DRN. BY: EAP	CK'D BY: HD6	DATE: 04/03	SCALE: NTS
SIZE: 40'-0" X 48'-0"	CODE: CUB	SHEET NO.: A3 OF 10	REV. #